

MOT. 542.920-926 | 940-945 | 947 | 948 | 956 | 957
MOT. 522.940-943 | 950
MOT. 942.910-912 | 925 | 930 | 960 | 967 | 970 | 980 | 990

OM 502 A | LA

Mercedes-Benz Motorbaumuster

Mercedes-Benz Engine Model | Modèle de moteur Mercedes-Benz | Modelo

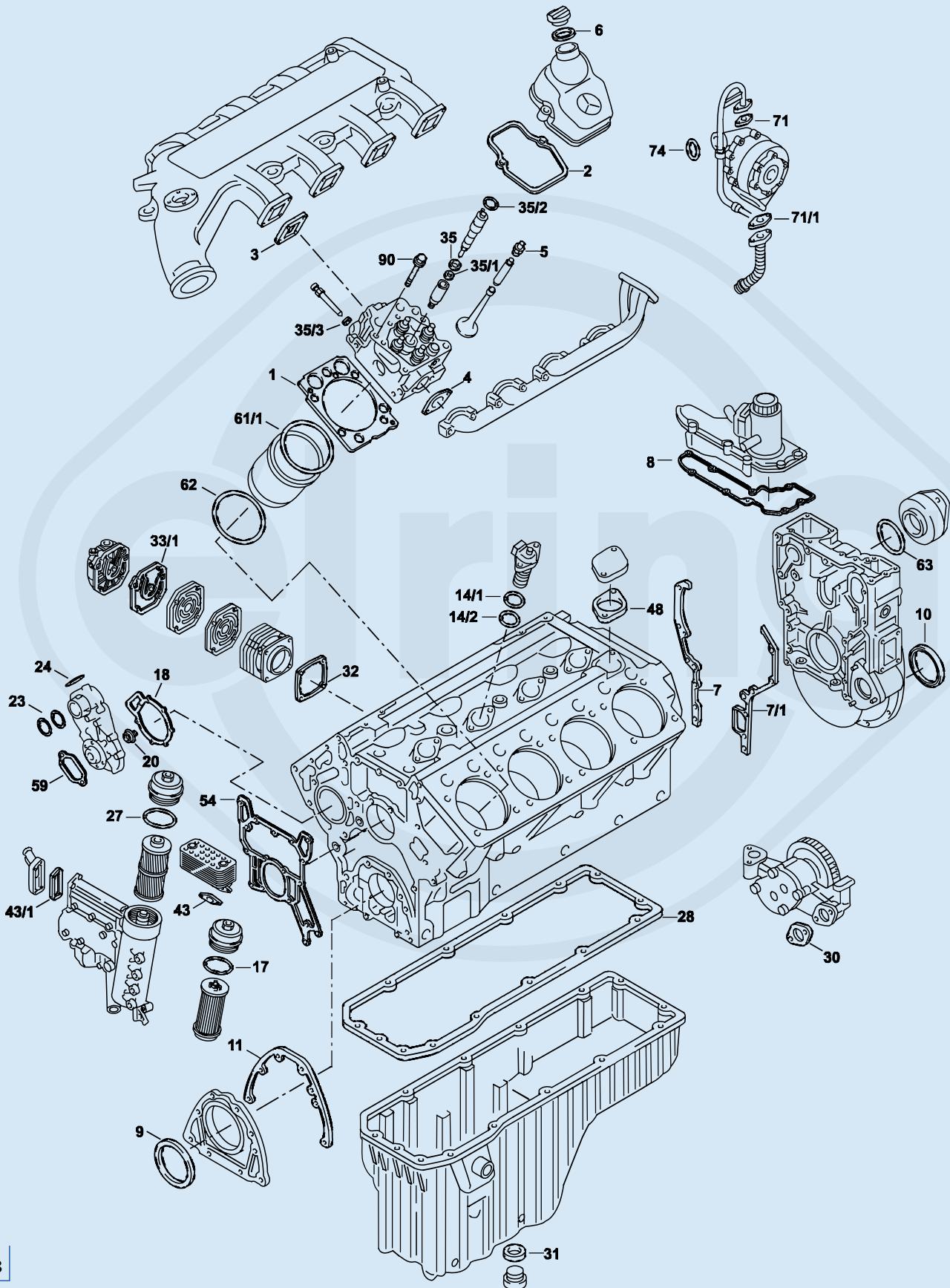

de motor Mercedes-Benz

Bild-Nr. Fig. No. No d'illustration Nº figura	Elring-Nr. Elring reference Référence Elring Referencia Elring	Stück Pieces Pièces Piezas	Teile-Nr. Part Number Référence Referencia	Bauart Material Abmessung Type Material Dimensions Type matériau dimension Tipo Material Medidas	Bemerkung Remarks Remarque Notas
S *	131.930	1	–	–	→ Mot. 012090
S *	131.950	1	–	–	Mot. 012091 → 084423
ZLBS	712.530	8	–	–	–
ES	447.214	8	541 010 11 20	–	→ Mot. 084423 incl. 862.562
ES	447.215	8	541 010 51 20	–	→ Mot. 084423 incl. 052.480
ES	711.442	8	541 010 25 20	–	Mot. 084424 → 155295 incl. 862.562
ES	711.444	8	541 010 52 20	–	Mot. 084424 → 155295 incl. 052.480
ES	001.830	8	457 010 42 20	–	Mot. 155296 → incl. 862.562
ES	001.832	8	457 010 62 20	–	Mot. 155296 → incl. 052.480
CS *	447.231	1	542 010 02 05	–	→ Mot. 012090
CS *	470.321	1	542 010 04 05	–	Mot. 012091 →
WPS	469.701	1	542 200 07 01	–	–
SZ	633.360	1	541 010 09 33	–	Steuergehäusesatz Timing cover set set pour carter de distribution Juego cuerpo de mando
SZ	066.460	1	906 017 02 60	–	O-Ringe für Zylinderkopf O-ring set for cylinder head joint torique pour culasse Juntas tóricas para culatas
ZKS	060.220	8	–	–	–
1	862.562	8	541 016 09 20	–	–
1	052.480	8	541 016 11 20	–	–
2	060.560	8	541 016 03 21	–	→ Mot. 084423
2	711.420	8	541 016 04 21	–	Mot. 084424 → 155295
2	001.790	8	457 016 01 21	–	Mot. 155296 →
3	470.290	8	541 098 04 80	–	–
4	432.040	8	541 142 01 80	–	–
5	814.882	32	000 053 35 58	9x12/15,4x11 FPM PR	–
6	a.A.	1	111 018 00 80	47,5x59x2,3 HNBR A	–
7	133.320	1	541 015 11 80	–	–
7/1	133.330	1	541 015 12 80	–	–
8	470.300	1	541 015 01 60	–	→ Mot. 089131
8	–	1	541 015 13 80	–	Mot. 089132 →
9	524.973	1	014 997 46 47	AW/BS RD FPM 105x130x12	–
10	562.920	1	013 997 14 47	AW/BS LD FPM 120x140x13	–
11	075.912	1	541 011 01 80	Metaloseal	–
14/1	152.610	8	023 997 64 48	47x52x2,5 FPM RD	–
14/2	152.630	8	023 997 65 48	45x50x2,5 FPM RD	–
17	–	1	022 997 89 48	–	–
18	a.A.	1	542 201 01 80	–	–
20	577.804	1	000 201 92 19	–	–
23	a.A.	2	024 997 28 48	–	–
24	201.240	1	942 501 00 80	–	–
27	–	1	021 997 27 48	–	–
28	445.990	1	542 014 03 22	–	→ Mot. 012090
28	470.090	1	542 014 04 22	–	Mot. 012091 →
30	759.309	1	917003 036003	–	–
31	125.105	1	007603 020103	20x26x1,5 CU A	–
31	133.400	1	007603 026101	26x32x2 CU A	–
32	452.021	2	541 131 07 80	–	–
33/1	401.651	1	541 131 09 80	–	–
35	124.870	8	906 017 02 60	–	–
35/1	a.A.	8	541 997 07 45	25x32,4x3,7 FPM RD	–
35/2	a.A.	8	541 997 05 45	20,9x3 FPM RD	–
35/3	a.A.	8	541 997 06 45	11x3 FPM RD	–
43	–	2	917003 028002	–	–