

Suitable to:

ZF 16K130 EcoSplit

ZF 16K160 EcoSplit

MAN

HIGH END GEARS

Parts for gearbox: 16K130,160

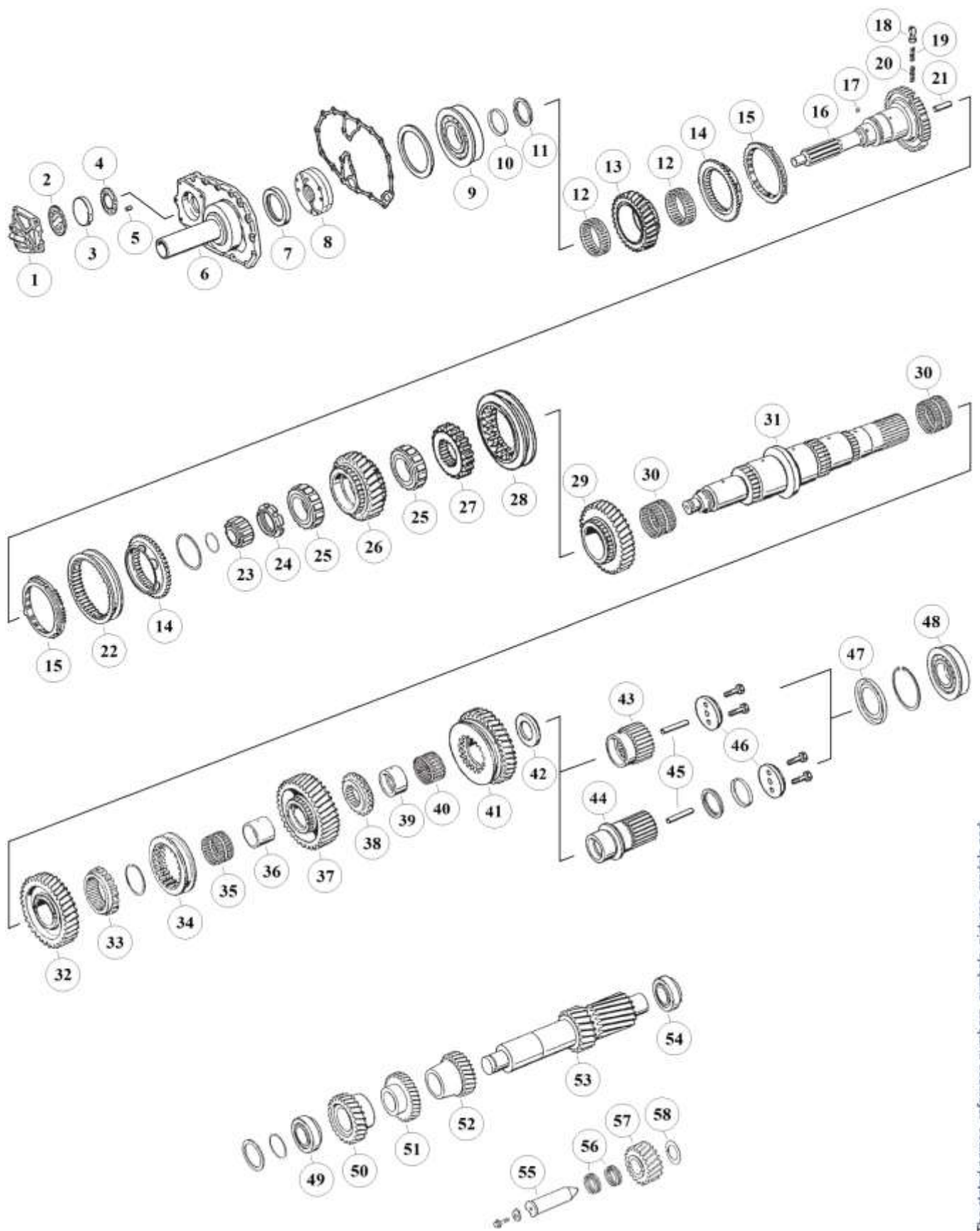

The stated names, reference numbers, symbols, pictures, models and descriptions of truck manufacturers serve only for comparison purposes. It is by no means allowed to use as some original reference towards vehicle owners.

RATIOS:

16K130 (1295)	I: 11,46 - 0,85	II: 13,68 - 1,00	III: 14,29 - 0,82
16K160 (1297)	I: 11,46 - 0,85	II: 13,68 - 1,00	III: 14,29 - 0,82

Fig.	MAET-No.	MAN-No.	ZF-No.	DESCRIPTION	Q-Ty.	Ratio	Note		
								16K130 (1295)	16K160 (1297)
1		81 32508 0064	1295 303 031	Cover	x1			■	■
2		81 32565 0001	0750 190 012	Disk	x1			■	■
3		81 32639 0010	1268 303 062	Piston	x1			■	■
4		81 32523 0100	0731 302 032	Pin	x1			■	■
5		81 32564 0007	1268 203 059	Washer	x1			■	■
6		81 32508 0063	1297 302 019	Front Cover	x1			■	■
6		81 32522 0035	1297 302 238	Front Cover	x1			■	■
7		81 96502 0225	0750 111 002	Oil Seal D.48x75x8	x1			■	■
7			0634 310 733	Oil Seal D.90x110x13	x1		(a)	■	■
7		81 96503 0342	0734 310 386	Oil Seal D.55x75x8	x1			■	■
7		81 96502 0225	0750 111 002	Oil Seal D.48x75x8	x1		(c)	■	■
8	00.116.024	81 32563 0005	1295 202 041	Oil Pump	x1			■	■
9		81 93420 0190	0750 118 131	Bearing D.80x150x27,5	x1			■	■
10	00.159.005	81 90820 0141	0730 061 816	Washer	x1			■	■
10	00.169.105	81 90820 0370	0730 062 579	Washer S.4,20 mm	x1			■	■
11	00.113.112	81 32521 0062	0730 103 244	Split Ring T.4,30 mm S.4,30 mm	x1		(d)	■	■
11		81 32521 0107	0730 103 935	Split Ring T.3,80 mm S.3,80 mm	x1		(d)	■	■
11	00.113.111	81 32521 0122	0730 105 156	Split Ring T.4,00 mm S.4,00 mm	x1		(e)	■	■
11			0730 105 154	Split Ring T.3,80 mm S.3,80 mm	x1		(e)	■	■
12		81 93402 0067	0735 320 786	Needle Cage D.88x96x24,5	x2			■	■
12		81 93402 0102	0735 320 896	Needle Cage D.88x96x29	x2			■	■
13	00.113.004	81 32301 0428	1295 302 070	Constant Gear 30 T.	x1	I		■	■
13	00.113.003	81 32301 0585	1295 302 071	Constant Gear 28 T.	x1	II		■	■
13	00.113.103	81 32301 0599	1295 302 122	Constant Gear 29 T.	x1	III		■	■
13	00.116.049	82 32301 0070	1297 302 177	Constant Gear 30 T.	x1	I		■	■
13	00.116.048	81 32301 0563	1297 302 176	Constant Gear 28 T.	x1	II		■	■
13	00.191.012	81 32301 0589	1297 302 250	Constant Gear 29 T.	x1	III		■	■
14	00.116.006	81 32425 0071	1295 304 278	Coupling Body	x2			■	■
15	00.116.009	81 32420 0081	1295 304 004	Synchronizer Ring	x2		old	■	■
15	00.116.109		1304 304 686	Synchronizer Ring	x2		new	■	■
16		81 32205 0147	1295 202 007	Input Shaft	x1			■	■
16		81 32205 0175	1295 202 039	Input Shaft	x1			■	■
16		81 32205 0173	1295 221 001	Input Shaft NMV130	x1		(Clutch PTO)	■	■
16	00.191.501	81 32205 0149	1297 202 008	Input Shaft	x1			■	■
16	00.191.201	81 32205 0176	1297 202 011	Input Shaft	x1			■	■
16		81 32205 0212	1297 202 045	Input Shaft	x1			■	■
17	00.151.094	06 32540 0118	0635 470 012	Needle	x1			■	■
18	00.168.075	81 32510 0005	1240 304 278	Pressure Block	x3			■	■
19	00.168.074	81 97601 0758	0732 040 386	Pressure Spring De.3x34	x3			■	■
20	00.168.076	81 97601 0757	0732 040 385	Pressure Spring De.6x34	x3			■	■
21			0730 062 323	Oil Tube	x1			■	■
22	00.116.028	81 32402 0101	1295 304 002	Sliding Sleeve	x1			■	■
23		81 93404 0028	0750 118 010	Roller Cage D.30x60x25,5	x1			■	■
23		81 93404 0174	0750 118 038	Roller Cage D.35x68x27,5	x1			■	■
24	00.113.130	81 90620 0074	3081 303 063	Grooved Nut M50x1,5	x1			■	■
24	00.113.030	81 90620 0073	0737 502 092	Grooved Nut M60x1,5	x1			■	■
25		81 93420 0135	0750 118 017	Roller Cage D.55x90x33	x2			■	■
25		81 93420 0133	0750 118 005	Roller Cage D.63x97,5x34,8	x2			■	■
26	00.116.313	81 32301 0445	1295 304 181	Gear 4th sp. 28 T.	x1	I		■	■

Special for MAN

The stated names, reference numbers, symbols, pictures, models and descriptions of truck manufacturers serve only for comparison purposes. It is by no means allowed to use as some original reference towards vehicle owners.

NOTES:

(a)	Only for 1295 221 001 Input Shaft (Fig.16)	(e)	Together with 0730 062 579 Washer (Fig.10)
(c)	Only for 1297 202 008 Input Shaft (Fig.16)	(f)	Only for old type with STRAIGHT TEETH
(d)	Together with 0730 061 816 Washer (Fig.10)	(g)	Only for models having MNV130

HIGH END GEARS

Parts for gearbox: 16K130,160

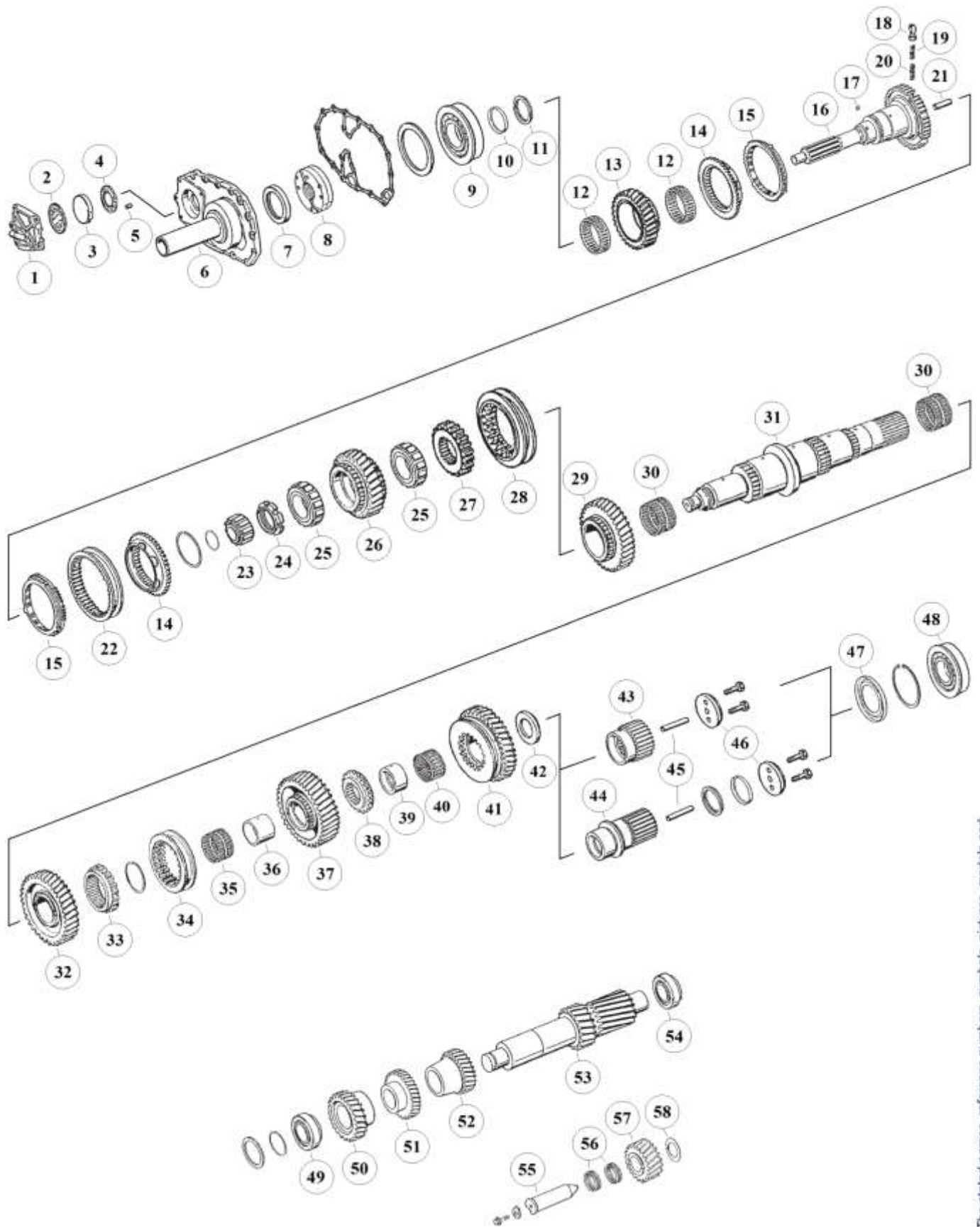

The stated names, reference numbers, symbols, pictures, models and descriptions of truck manufacturers serve only for comparison purposes. It is by no means allowed to use as some original reference towards vehicle owners.

RATIOS:

16K130 (1295)	I: 11,46 - 0,85	II: 13,68 - 1,00	III: 14,29 - 0,82
16K160 (1297)	I: 11,46 - 0,85	II: 13,68 - 1,00	III: 14,29 - 0,82

Fig.	MAET-No.	MAN-No.	ZF-No.	DESCRIPTION	Q-Ty.	Ratio	Note		
								16K130 (1295)	16K160 (1297)
26			1295 304 182	Gear 4th sp. 30 T.	x1	II		■	
26	00.116.413	81 32301 0602	1295 304 303	Gear 4th sp. 26 T.	x1	III		■	
26	00.116.113	81 32301 0465	1297 304 128	Gear 4th sp. 28 T.	x1	I			■
26	00.116.013	81 32301 0568	1297 304 127	Gear 4th sp. 30 T.	x1	II			■
26	00.116.513	81 32301 0592	1297 304 258	Gear 4th sp. 29 T.	x1	III			■
27	00.116.130	81 32403 0061	1295 304 234	Synchronizer Hub	x1			■	
27	00.116.030	81 32403 0058	1297 304 188	Synchronizer Hub	x1				■
28	00.116.127	81 32402 0104	1295 304 179	Sliding Sleeve	x1			■	
28	00.116.027	81 32402 0106	1297 304 120	Sliding Sleeve	x1				■
29	00.116.231	81 32301 0442	1295 304 188	Gear 3rd sp. 32 T.	x1	I&III		■	
29			1295 304 187	Gear 3rd sp. 34 T.	x1	II		■	
29	00.116.131	81 32301 0464	1297 304 116	Gear 3rd sp. 32 T.	x1	I&III			■
29	00.116.031		1297 304 115	Gear 3rd sp. 34 T.	x1	II			■
30		81 93402 0072	0735 320 460	Needle Cage D.82x90x46	x2			■	
30		81 93402 0068	0735 320 418	Needle Cage D.82x90x49	x2				■
31	00.116.115	81 32202 0040	1295 304 243	Main Shaft	x1	I&II		■	
31	00.116.215	81 32202 0050	1295 304 304	Main Shaft	x1	III		■	
31	00.116.015		1297 304 179	Main Shaft	x1	I&II			■
31		81 32202 0049	1297 304 264	Main Shaft	x1	III			■
32	00.116.222	81 32301 0440	1295 304 185	Gear 2nd sp. 37 T.	x1	I&III		■	
32			1295 304 184	Gear 2nd sp. 38 T.	x1	II		■	
32	00.116.122	81 32301 0461	1297 304 113	Gear 2nd sp. 37 T.	x1	I&III			■
32	00.116.022		1297 304 112	Gear 2nd sp. 38 T.	x1	II			■
33	00.116.032	81 32403 0055	1295 304 235	Synchronizer Hub	x1			■	■
34	00.116.133	81 32402 0103	1295 304 178	Sliding Sleeve	x1			■	
34	00.116.033	81 32402 0105	1297 304 119	Sliding Sleeve	x1				■
35		81 93402 0087	0735 320 461	Needle Cage D.72x80x46	x1			■	
35		81 93402 0073	0735 320 568	Needle Cage D.82x90x53	x1				■
36	00.116.085	81 32220 0058	1297 304 055	Bushing	x1				■
37	00.116.134	81 32301 0493	1295 304 204	Gear 1st sp. 44 T.	x1	I&III		■	
37		81 32301 0441	1295 304 194	Gear 1st sp. 44 T.	x1	I	(f)	■	
37			1295 304 205	Gear 1st sp. 47 T.	x1	II		■	
37	00.116.234	81 32301 0498	1297 304 151	Gear 1st sp. 44 T.	x1	I&III			■
37	00.116.034		1297 304 150	Gear 1st sp. 47 T.	x1	II			■
38	00.191.138	81 32425 0072	1295 304 206	Follower	x1			■	
38		81 32425 0063	1295 304 024	Follower	x1		(f)	■	
38	00.191.038	81 32425 0075	1297 304 154	Follower	x1				■
39	00.191.285	81 32220 0056	1295 304 012	Bushing D.60x75x38	x1	I&II		■	
39	00.191.185	81 32220 0059	1297 304 034	Bushing	x1	I&II			■
40		81 93402 0088	0750 115 059	Needle Cage D.75x83x40	x1			■	
40		81 93402 0074	0735 320 486	Needle Cage D.78x86x44	x1				■
41	00.113.028	81 32301 0494	1295 304 201	Reverse Gear 39 T.	x1	I&III		■	
41		81 32301 0438	1295 304 115	Reverse Gear 39 T.	x1	I	(f)	■	
41	00.113.128	81 32301 0778	1295 304 200	Reverse Gear 38 T.	x1	II		■	
41	00.191.035	81 32301 0499	1297 304 149	Reverse Gear 39 T.	x1	I&III			■
41	00.191.135		1297 304 148	Reverse Gear 38 T.	x1	II			■
42		81 32312 0746	1295 304 241	Washer	x1	I&II		■	
42		81 32312 0667	1295 304 176	Washer		I	(f)	■	
42			1297 304 177	Washer	x1	I&II			■

Special for MAN

The stated names, reference numbers, symbols, pictures, models and descriptions of truck manufacturers serve only for comparison purposes. It is by no means allowed to use as some original reference towards vehicle owners.

NOTES:

(a)	Only for 1295 221 001 Input Shaft (Fig.16)	(e)	Together with 0730 062 579 Washer (Fig.10)
(c)	Only for 1297 202 008 Input Shaft (Fig.16)	(f)	Only for old type with STRAIGHT TEETH
(d)	Together with 0730 061 816 Washer (Fig.10)	(g)	Only for models having MNV130

HIGH END GEARS

Parts for gearbox: 16K130,160

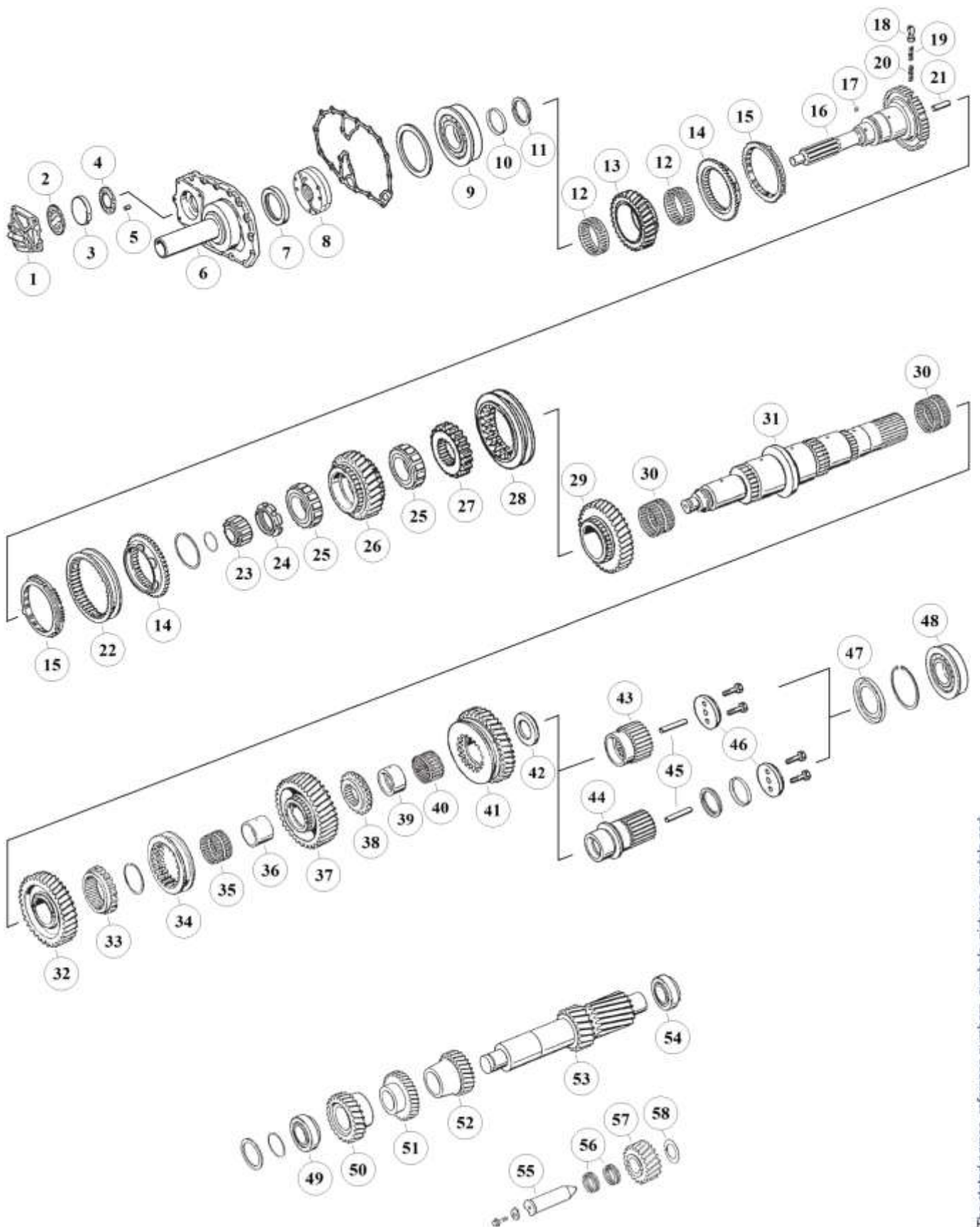

The stated names, reference numbers, symbols, pictures, models and descriptions of truck manufacturers serve only for comparison purposes. It is by no means allowed to use as some original reference towards vehicle owners.

RATIOS:

16K130 (1295)	I: 11,46 - 0,85	II: 13,68 - 1,00	III: 14,29 - 0,82
16K160 (1297)	I: 11,46 - 0,85	II: 13,68 - 1,00	III: 14,29 - 0,82

HIGH END GEARS

Parts for gearbox: 16K130,160

Fig.	MAET-No.	MAN-No.	ZF-No.	DESCRIPTION	Q-Ty.	Ratio	Note	16K130 (1295)		16K160 (1297)	
43	00.112.044	81 32301 0495	1295 304 247	Sun Gear 27 T.	x1	I&II		■			
43	00.116.044	81 32301 0466	1297 304 187	Sun Gear 27 T.	x1	I&II			■		
44		81 32301 0603	1295 304 251	Sun Gear 24 T.	x1	III		■			
44		81 32301 0593	1297 304 265	Sun Gear 24 T.	x1	III			■		
45		81 32562 0008	0730 061 842	Oil Tube	x1			■			
46	00.159.012	81 32312 0710	1272 304 021	Thrust Washer	x1			■			
47		81 32147 0008	1295 304 129	Oil Collector	x1	I&II		■			
47		81 32312 0854	1297 301 004	Oil Collector	x1	III			■		
48		81 93420 0129	0750 118 153	Bearing D.60x130x31	x1	I&II		■			
48		81 93420 0177	0750 118 137	Bearing D.80x140x26	x1	III			■		
49		81 93420 0132	0750 117 010	Bearing D.50,80x100x35	x1			■			
50	00.113.018	81 32301 0430	1295 303 036	Constant Gear 31 T.	x1	I		■			
50	00.113.017	81 32301 0696	1295 303 101	Constant Gear 34 T.	x1	II			■		
50	00.113.117	81 32301 0600	1295 303 060	Constant Gear 32 T.	x1	III		■			
50	00.116.036	81 32301 0460	1297 303 074	Constant Gear 31 T.	x1	I				■	
50	00.116.035	81 32301 0565	1297 303 066	Constant Gear 34 T.	x1	II				■	
50	00.191.017	81 32301 0590	1297 303 098	Constant Gear 32 T.	x1	III				■	
51	00.113.019	81 32301 0431	1295 303 028	Gear 4th sp. 34 T.	x1	I		■			
51	00.113.016	81 32301 0737	1295 303 027	Gear 4th sp. 31 T.	x1	II			■		
51	00.113.116	81 32301 0598	1295 303 094	Gear 4th sp. 35 T.	x1	III		■			
51	00.116.021	82 32301 0072	1297 303 072	Gear 4th sp. 34 T.	x1	I				■	
51	00.116.020	81 32301 0564	1297 303 065	Gear 4th sp. 31 T.	x1	II				■	
51		82 32301 0053	1297 303 114	Gear 4th sp. 39 T.	x1	III				■	
52	00.116.116	81 32301 0439	1295 303 005	Gear 3rd sp. 28 T.	x1	I&III		■			
52			1295 303 006	Gear 3rd sp. 25 T.	x1	II			■		
52	00.110.216	81 32301 0458	1297 303 081	Gear 3rd sp. 28 T.	x1	I&III				■	
52	00.116.016	81 32301 0572	1297 303 077	Gear 3rd sp. 25 T.	x1	II				■	
53	00.116.126	81 32206 0051	1295 303 056	Counter Shaft 19-23 T.	x1	I&III		■			
53		81 32206 0049	1295 303 042	Counter Shaft 19-23 T.	x1	I	(f)	■			
53			1295 303 089	Counter Shaft 19-23 T.	x1	I&III	(g)	■			
53			1295 303 055	Counter Shaft 17-20 T.	x1	II		■			
53	00.116.226	81 32206 0053	1297 303 048	Counter Shaft 19-23 T.	x1	I&III				■	
53			1297 303 070	Counter Shaft 19-23 T.	x1	I&III	(g)			■	
53	00.116.026	81 32206 0057	1297 303 047	Counter Shaft 17-20 T.	x1	II				■	
54		81 93420 0134	0750 117 011	Bearing D.50,8x104,7x39,6	x1			■			
54		81 93420 0131	0750 117 008	Bearing D.50x110x42	x1					■	
55	00.151.092	81 32317 0032	1295 305 056	Reverse Idler Pin	x1			■			
56		81 93402 0066	0750 115 011	Needle Cage D.45x53x21	x2			■			
57	00.191.036	81 32315 0034	1295 305 051	Reverse Idler Gear 21 T.	x1	I&III		■			
57		81 32315 0031	1297 305 003	Reverse Idler Gear 21 T.	x1	I	(f)	■			
57	00.113.029	81 32315 0038	1295 305 052	Reverse Idler Gear 24 T.	x1	II		■			
58	00.168.038	81 32315 0153	0730 150 064	Washer	x1			■			

Special for MAN

The stated names, reference numbers, symbols, pictures, models and descriptions of truck manufacturers serve only for comparison purposes. It is by no means allowed to use as some original reference towards vehicle owners.

6

NOTES:

(a)	Only for 1295 221 001 Input Shaft (Fig.16)	(e)	Together with 0730 062 579 Washer (Fig.10)
(c)	Only for 1297 202 008 Input Shaft (Fig.16)	(f)	Only for old type with STRAIGHT TEETH
(d)	Together with 0730 061 816 Washer (Fig.10)	(g)	Only for models having MNV130

HIGH END GEARS

Parts for gearbox: 16K130,160

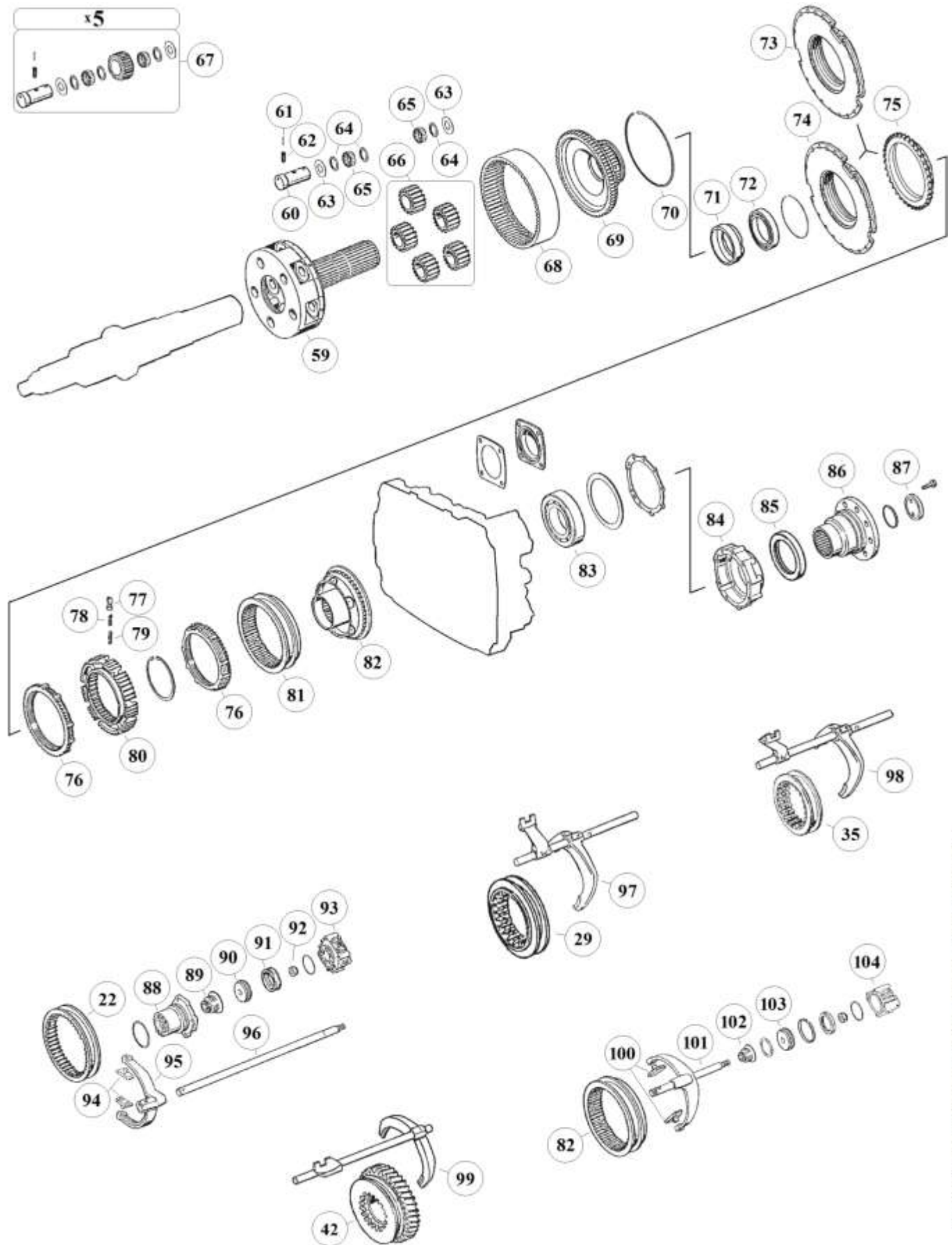

The stated names, reference numbers, symbols, pictures, models and descriptions of truck manufacturers serve only for comparison purposes. It is by no means allowed to use as some original reference towards vehicle owners.

RATIOS:

16K130 (1295)	I: 11,46 - 0,85	II: 13,68 - 1,00	III: 14,29 - 0,82
16K160 (1297)	I: 11,46 - 0,85	II: 13,68 - 1,00	III: 14,29 - 0,82

Fig.	MAET-No.	MAN-No.	ZF-No.	DESCRIPTION	Q-Ty.	Ratio	Note		
								16K130 (1295)	16K160 (1297)
59	00.116.301	81 32403 0078	1295 232 044	Planet Carrier	x1	I&II		■	
59	00.116.401	81 32403 0088	1295 232 045	Planet Carrier	x1	III		■	
59	00.116.501	81 32403 0066	1297 232 039	Planet Carrier	x1	I&II			■
59		81 32403 0079	1297 232 045	Planet Carrier	x1	III			■
60	00.110.202	81 32523 0086	1269 332 036	Planet Pin	x5			■	
60	00.116.202	81 32523 0111	1297 332 109	Planet Pin	x5				■
61	00.116.220	06 22120 0512	0631 329 017	Lock Pin D.3x24	x5			■	
62	00.116.221	06 22120 0912	0631 329 050	Lock Pin D.5x24	x5			■	
63	00.110.204	81 90712 0494	0501 305 887	Washer D.29x57,50x1,50	x10			■	
63	00.116.223	81 32312 0707	0501 306 212	Washer D.29x64x1,5	x10				■
64	00.111.201	81 90712 0495	0730 103 846	Washer D.29x39x1,00	x15			■	
65	00.110.205	81 93403 0010	0735 470 057	Needle D.6x14,75	x180			■	
65	00.116.205	81 32528 0014	0750 119 109	Needle D.10x16,80	x120				■
66	00.112.206	81 32301 6002	1295 232 027	Planet Gear	x5	I&II		■	
66		81 32301 6008	1295 232 038	Planet Gear	x5	III		■	
66	00.116.206	81 32301 6003	1297 232 023	Planet Gear	x5	I&II			■
66	00.191.206	81 32301 6007	1297 232 024	Planet Gear	x5	III			■
67	00.112.219		1296 298 904	Repair Kit	x1	I&II		■	
67	00.116.219		1297 298 912	Repair Kit	x1	I&II			■
67			1297 298 919	Repair Kit	x1	III			■
68		81 32301 0444	1295 332 053	Carrier Crown 83 T.	x1	I&II		■	
68	00.151.207	81 32301 0604	1295 332 086	Carrier Crown 86 T.	x1	III		■	
68	00.151.307	81 32301 0691	1297 332 080	Carrier Crown 83 T.	x1	I&II			■
69	00.151.304	81 32403 0052	1295 332 021	Intermediate Carrier 83 T.	x1	I&II		■	
69		81 32403 0073	1295 332 084	Intermediate Carrier 86 T.	x1	III		■	
69	00.191.204	81 32403 0057	1297 332 017	Intermediate Carrier 83 T.	x1	I&II			■
69	00.191.304	81 32403 0070	1297 332 035	Intermediate Carrier 86 T.	x1	III			■
70	00.151.290	81 90820 0284	0730 505 055	Lock Ring	x1	I&II		■	
70	00.151.190	81 90820 0371	0730 505 056	Lock Ring	x1	III		■	
71	00.113.204	81 32312 0708	1297 332 002	Ring	x1				■
72		06 31429 0075	0750 116 166	Bearing D.75x105x16	x1			■	
72		81 93410 0083	0750 116 165	Bearing D.80x110x16	x1				■
73	00.116.008	81 32425 0073	1296 233 006	Coupling Flange (assembly)	x1		opt. w. Fig.74+75	■	■
74	00.151.308		1296 333 046	Coupling Flange (disassembled)	x1		only w. Fig.75	■	■
75	00.151.213	81 32425 0141	1296 333 050	Coupling Body (disassembled)	x1		only w. Fig.74	■	■
76	00.112.210	81 32420 0096	1296 333 022	Synchronizer Ring	x2		old	■	■
76	00.151.210	81 32420 0236	1296 333 045	Synchronizer Ring	x2		new	■	■
77	00.168.075	81 32510 0005	1240 304 278	Pressure Block	x9			■	■
78	00.168.074	81 97601 0758	0732 040 386	Pressure Spring De.3x34	x9			■	■
79	00.168.076	81 97601 0757	0732 040 385	Pressure Spring D.6x34	x9			■	■
80	00.116.004	81 32420 0095	1296 333 002	Synchronizer Hub	x1			■	■
81	00.116.003	81 32402 0111	1296 333 023	Sliding Sleeve	x1			■	■
82	00.112.213	81 32425 0074	1295 233 025	Coupling Body (36 Spl.)	x1			■	
82	00.116.213	81 32425 0083	1313 233 001	Coupling Body (38 Spl.)	x1				■
83		81 93410 0046	0750 116 002	Bearing D.90x160x30	x1			■	■
84		81 32106 0072	1296 301 067	Cover	x1			■	■
84		81 32106 0152	1315 301 220	Cover	x1			■	■
85		81 96503 0236	0750 111 341	Oil Seal 105x130x12	x1			■	■
86	00.113.065	81 39115 0215	1295 338 061	Output Flange D.180-4 H.	x1			■	■

Special for MAN

The stated names, reference numbers, symbols, pictures, models and descriptions of truck manufacturers serve only for comparison purposes. It is by no means allowed to use as some original reference towards vehicle owners.



NOTES:

HIGH END GEARS

Parts for gearbox: 16K130,160

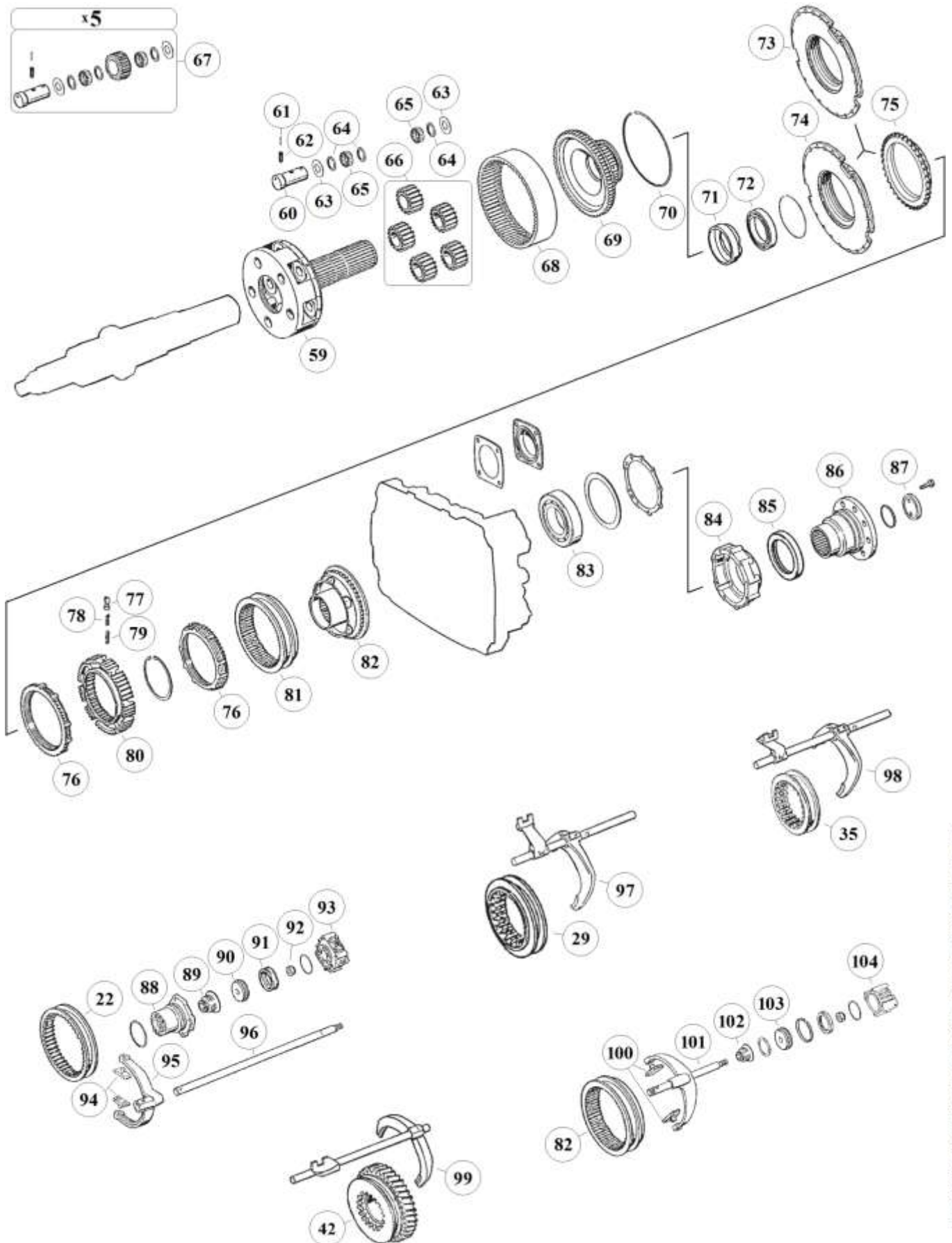

The stated names, reference numbers, symbols, pictures, models and descriptions of truck manufacturers serve only for comparison purposes. It is by no means allowed to use as some original reference towards vehicle owners.

RATIOS:

16K130 (1295)	I: 11,46 - 0,85	II: 13,68 - 1,00	III: 14,29 - 0,82
16K160 (1297)	I: 11,46 - 0,85	II: 13,68 - 1,00	III: 14,29 - 0,82

Fig.	MAET-No.	MAN-No.	ZF-No.	DESCRIPTION	Q-Ty.	Ratio	Note		
								16K130 (1295)	16K160 (1297)
86	00.113.105	81 39115 0171	1295 338 014	Output Flange D.180-10 H.	x1			■	
86	00.151.065	81 39115 0224	1297 338 041	Output Flange D.180-4 H.	x1				■
86	00.151.165	81 39115 0178	1297 338 010	Output Flange D.180-10 H.	x1				■
87		81 32312 0820	1295 332 051	Thrust Washer	x1			■	■
88	00.151.093	81 32638 0005	1296 312 042	Cylinder	x1			■	
89		81 96401 0148	0750 112 034	Cap Collar D.25x38x14,2	x1			■	■
90		81 32639 0014	1296 312 053	Piston	x1			■	
91		81 96503 0019	0750 112 089	Ring 53x63x16,2	x1			■	
92		81 90501 0188	0737 006 095	Nut	x1			■	
93		81 52170 6091	0750 132 032	Cylinder	x1			■	■
93		81 52170 6067	1295 212 008	Cylinder	x1			■	■
93		81 52170 6095	0750 132 033	Cylinder	x1				■
94	00.110.035	81 32526 0029	1295 306 132	Sliding Pads	x2		(Bronze)	■	■
95		81 32516 0119	1313 312 002	Fork	x1			■	■
96		81 32518 0110	1295 312 017	Shifting Rod	x1			■	
96		81 32518 0115	1297 312 007	Shifting Rod	x1				■
97		81 32518 6034	1295 206 184	Fork	x1			■	
97		81 32518 6021	1295 206 189	Fork	x1			■	
97		81 32518 0128	1297 206 077	Fork	x1				■
97			1297 206 083	Fork	x1				■
98			1295 206 182	Fork	x1			■	
98		81 32518 6020	1295 206 188	Fork	x1			■	
98		81 32518 0129	1297 206 076	Fork	x1				■
98			1297 206 082	Fork	x1				■
99		81 32518 6040	1295 206 253	Fork	x1			■	
99			1295 206 252	Fork	x1			■	
99			1297 206 172	Fork	x1				■
99			1297 206 173	Fork	x1				■
99		81 32518 6013	1297 206 184	Fork	x1				■
100		81 32526 0026	1296 334 004	Sliding Pads	x2		(Bronze)	■	■
101		81 32518 0190	1313 234 011	Fork	x1			■	
101		81 32518 6042	1312 234 002	Shifting Rod (assembly)	x1				■
102		81 96401 0148	0750 112 034	Cap Collar D.25x38x14,2	x1			■	■
103		81 32639 0019	1296 334 039	Piston	x1			■	■
104		81 32638 0006	1295 334 075	Cylinder	x1			■	■

Special for MAN

The stated names, reference numbers, symbols, pictures, models and descriptions of truck manufacturers serve only for comparison purposes. It is by no means allowed to use as some original reference towards vehicle owners.

NOTES:

HIGH END GEARS