

**Suitable to:**  
**ZF S6-85 EcoLite**

**MAN**

# HIGH END GEARS

## Parts for gearbox: S6-85

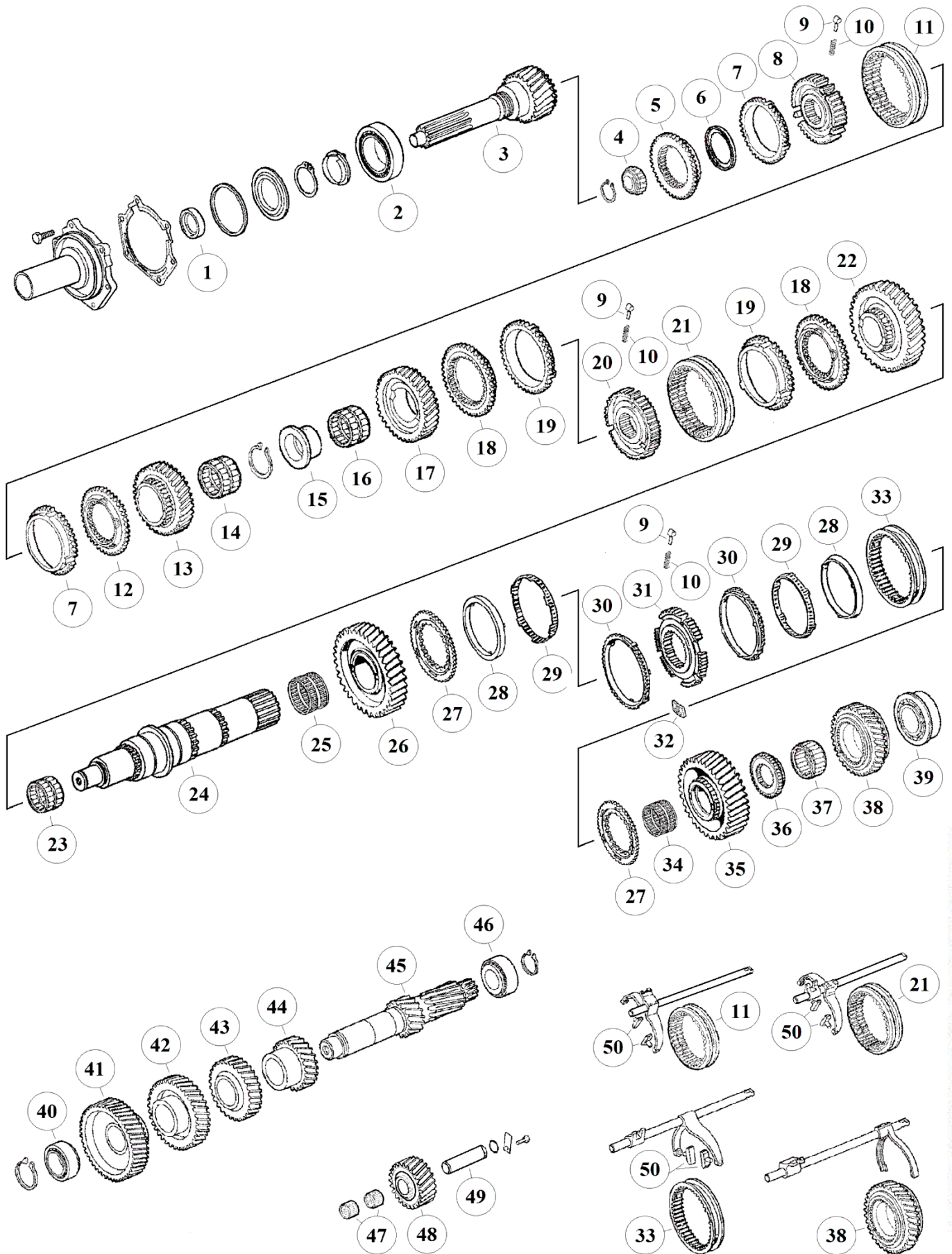

RATIOS:

The stated names, reference numbers, symbols, pictures, models and descriptions of truck manufacturers serve only for comparison purposes. It is by no means allowed to use as some original reference towards vehicle owners.

Fig.	MAET-No.	MAN-No.	ZF-No.	DESCRIPTION	Q-Ty.	Note	S6-85/6,75-0,83	S6-87,72-1,00
1		81 96502 0934	0750 111 149	Oil Seal D.48x65x10	x1		■	■
2		81 93420 0261	0750 117 347	Bearing D.70x115x29	x1		■	■
3	00.185.001	81 32205 0237	1310 302 001	Input Shaft	x1		■	
3			1310 302 025	Input Shaft	x1		■	
3			1310 302 032	Input Shaft	x1		■	
3			1310 302 026	Input Shaft	x1			■
3	00.185.101		1310 302 022	Input Shaft	x1			■
3			1310 302 021	Input Shaft	x1			■
3	00.185.201		1310 302 033	Input Shaft	x1			■
4		81 93501 0093	0750 117 562	Roller Cage D.28x32	x1		■	■
5	00.185.012	81 32425 0124	1310 302 023	Coupling Body HO	x1		■	
5	00.185.112		1310 302 024	Coupling Body HO	x1			■
6		81 32313 0244	0501 313 171	Oil Seal	x1		■	■
7	00.185.042	81 32420 0175	1311 304 076	Synchronizer Ring	x2	old	■	■
7	00.185.142	81 32420 0231	1311 304 255	Synchronizer Ring	x2	new	■	■
8	00.185.008	81 32420 0191	1311 304 226	Synchronizer Hub	x1		■	■
9	00.151.080	81 32510 0013	1297 304 436	Pressure Block	x9		■	■
10	00.175.205	81 97601 0895	0732 040 409	Pressure Spring D.6,5x23,5	x9		■	■
11	00.185.009	81 32402 0166	1304 304 664	Sliding Sleeve	x1		■	■
12	00.185.052	81 32425 0108	1311 304 009	Coupling Body	x1		■	■
13	00.185.004	81 32301 0896	1310 304 091	Gear 6th sp. 23 T.	x1		■	
13	00.185.005		1310 304 092	Gear 5th sp. 26 T.	x1			■
14		81 93402 0123	0735 321 543	Roller Cage D.52x60x23	x1		■	■
15	00.185.006	81 93001 0346	1311 304 124	Bushing	x1		■	■
16		81 93402 0032	0735 320 493	Roller Cage D.70x78x36,50	x1		■	■
17	00.185.014	81 32301 0895	1310 304 088	Gear 4th sp. 29 T.	x1		■	
17	00.185.104		1310 304 093	Gear 4th sp. 30 T.	x1			■
18	00.151.006	81 32425 0092	1312 304 027	Coupling Body	x2		■	■
19	00.151.054	81 32420 0146	1297 304 402	Synchronizer Ring	x2	old	■	■
19	00.151.154	81 32420 0230	1297 304 484	Synchronizer Ring	x2	new	■	■
20	00.185.035	81 32420 0226	1310 304 080	Synchronizer Hub	x1		■	■
21	00.151.028	81 32402 0197	1310 304 202	Sliding Sleeve	x1		■	■
22		81 32301 0894	1310 304 085	Gear 3rd sp. 35 T.	x1		■	
22	00.185.013		1310 304 124	Gear 3rd sp. 37 T.	x1			■
23		81 93402 0124	0735 321 106	Needle Cage D.80x88x48	x1		■	■
24	00.185.015	81 32202 0102	1311 304 248	Main Shaft	x1		■	■
25		81 93402 0124	0735 321 106	Needle Cage D.80x88x48	x1		■	■
26	00.185.011	81 32301 0892	1310 304 012	Gear 2nd sp. 43 T.	x1		■	■
27	00.151.413	81 32425 0103	1312 304 106	Synchronizer Ring Disk	x2		■	■
28	00.151.068	81 32420 0163	1268 304 424	Intermediate Cone	x2		■	■
29	00.151.069	81 30120 0051	1268 304 494	Intermediate Synchr. Ring	x2		■	■
30	00.151.152	81 32420 0161	1268 304 525	Synchronizer Ring	x2		■	■
31	00.185.135	81 32420 0225	1310 304 157	Synchronizer Hub	x1		■	■
32	00 151 380	81 38108 0005	1312 304 159	Locking Plate	x3		■	■
33	00.151.043	81 32402 0191	1310 304 175	Sliding Sleeve	x1		■	■
34		81 93402 0125	0735 321 108	Needle Cage D.75x83x50	x1		■	■
35	00.185.010	81 32301 0891	1310 304 011	Gear 1st Speed 50 T.	x1		■	■
36	00.185.235	81 32425 0130	1311 304 250	Synchronizer Hub	x1		■	■
37		81 93402 0148	0735 298 255	Roller Cage D.70x86x42,5	x1		■	■

Special for MAN

The stated names, reference numbers, symbols, pictures, models and descriptions of truck manufacturers serve only for comparison purposes. It is by no means allowed to use as some original reference towards vehicle owners.

NOTES:

# HIGH END GEARS

## Parts for gearbox: S6-85

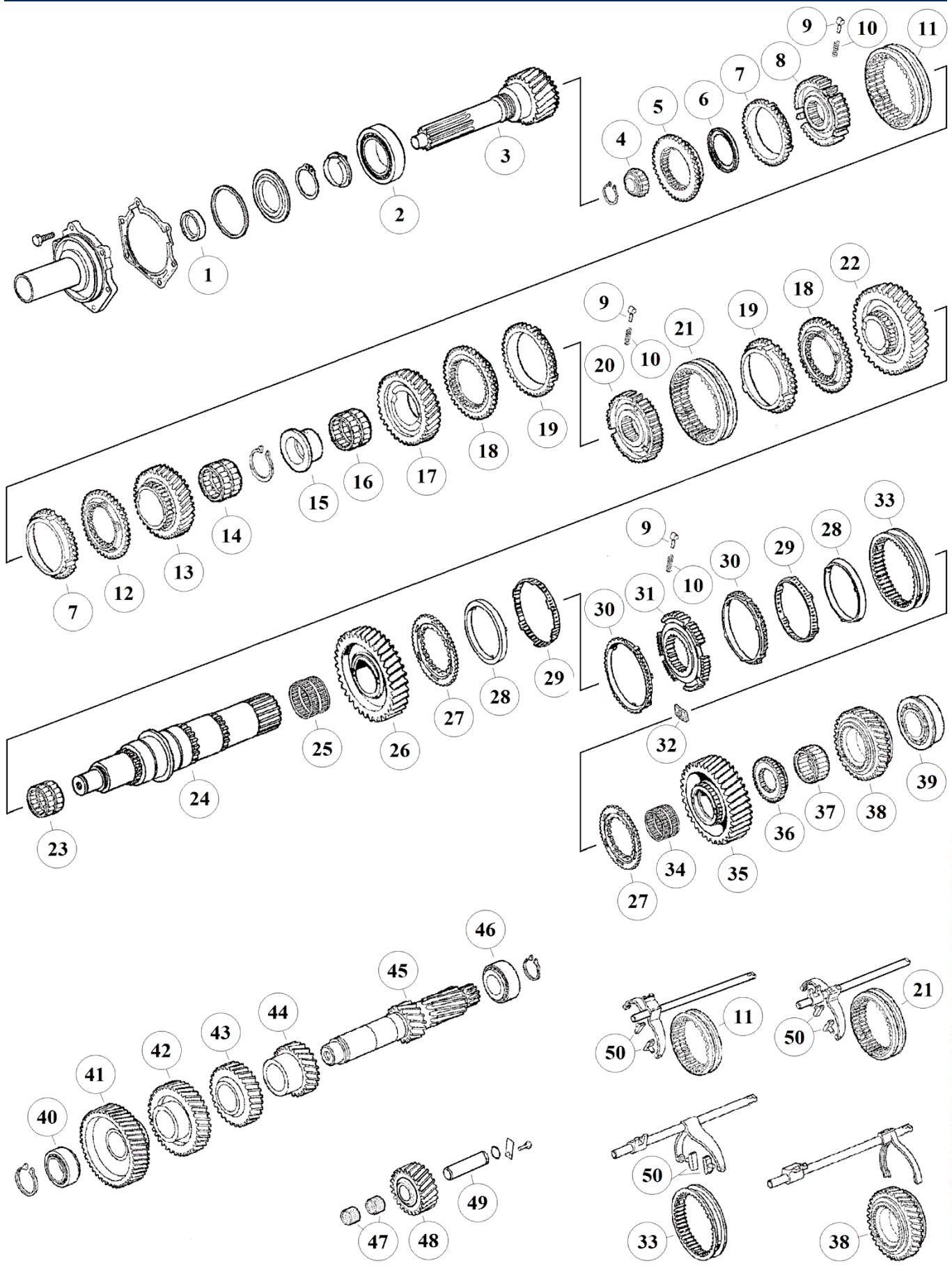

RATIOS:

The stated names, reference numbers, symbols, pictures, models and descriptions of truck manufacturers serve only for comparison purposes. It is by no means allowed to use as some original reference towards vehicle owners.

Fig.	MAET-No.	MAN-No.	ZF-No.	DESCRIPTION	Q-Ty.	Note		
							S6-85/6,75-0,83	S6-85/7,72-1,00
38	00.185.029	81 32302 0045	1310 304 200	Reverse Gear	x1		■	■
39		81 93420 0262	0735 370 730	Bearing D.60x120x29,7	x1		■	■
40		81 93420 6029	0750 117 083	Bearing D.50,8x95,2x27,7.	x1		■	■
41	00.185.016	81 32301 0888	1310 303 032	Constant Gear 47 T.	x1		■	■
41	00.185.017		1310 303 044	Constant Gear 50 T.	x1		■	■
42	00.185.018	81 32301 0889	1310 303 033	Gear 6th sp. 45 T.	x1		■	■
42	00.185.019		1310 303 045	Gear 5th sp. 37 T.	x1		■	■
43	00.185.020	81 32301 0890	1310 303 051	Gear 4th sp. 32 T.	x1		■	■
43	00.185.021		1310 303 050	Gear 4th sp. 29 T.	x1		■	■
44	00.185.022	81 32301 0887	1310 303 031	Gear 3rd sp. 24 T.	x1		■	■
44	00.185.024		1310 303 052	Gear 3rd sp. 24 T.	x1		■	■
45	00.185.023		1310 303 076	Counter Shaft	x1		■	■
46		81 93420 6030	1246 203 008	Bearing D.44,45x95,25x28	x1		■	■
47		81 93402 0121	0750 115 233	Needle Cage D.30x38x30	x2		■	■
48	00.185.129	81 32301 0886	1310 305 003	Reverse Idler Gear 21 T.	x1		■	■
49	00.185.229	81 91001 0599	1310 305 001	Reverse Idler Pin	x1		■	■
50	00.109.180	81 32526 0027	1290 306 066	Sliding Pads	x6	(Bronze)	■	■

**Special for MAN**

The stated names, reference numbers, symbols, pictures, models and descriptions of truck manufacturers serve only for comparison purposes. It is by no means allowed to use as some original reference towards vehicle owners.

NOTES:

# HIGH END GEARS